



ACCELA PRO



MANUAL

WWW.JBJAQUARIUM.COM

TABLE OF CONTENTS

Important Safety Instructions	3—5
Parts	6
Introduction	7
Getting Started	8-11
Controls	12-16
Maintenance	17
Warranty	18-19

Important Safety Instructions

WARNING

To guard against injury, basic safety precautions should be observed, including the following:

READ ALL SAFETY INSTRUCTIONS BEFORE USE.

DANGER

To avoid possible electric shock, special care should be taken since water is employed in the use of aquarium equipment. For each of the following situations, do not attempt to repair yourself: return the appliance to an authorized service facility for service or discard the appliance.

- A. If the appliance falls into water, DON'T reach for it! First unplug it and then retrieve it. If the electrical components of the appliance get wet, unplug the appliance immediately.
- B. Carefully examine the appliance after installation. It should not be plugged in if there is water on parts not intended to be wet.
- C. Do not operate any appliance if it has a damaged cord or plug, or if it is malfunctioning or if it is dropped or damaged in any manner.
- D. To avoid the possibility of the appliance plug or receptacle getting wet, position aquarium stand and tank to one side of a wall mounted receptacle to prevent water from dripping onto the receptacle or plug. A "drip loop", shown in the Figure at the right should be arranged by the user for each cord connecting an aquarium appliance to a receptacle. The "drip loop" is that part of the cord below the level of the receptacle or the connector if an extension cord is used, to prevent water travel along the cord and coming in contact with the receptacle. (Continued on pg. 4)

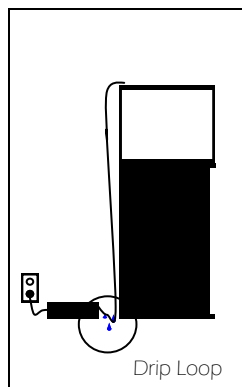

Important Safety Instructions

D. (Continued from pg. 3)

If the plug or the receptacle do get wet, DON'T unplug the cord. Disconnect the fuse to the circuit breaker that supplies power to the appliance. Then unplug and examine for the presence of water in the receptacle.

E. Close supervision is necessary when any appliance is used by or near children.

F. To avoid injury, do not contact moving parts or hot parts such as heaters, reflectors, lamp bulbs, and etc.

G. Always unplug an appliance from the outlet when not in use, before putting on or taking off parts, and before cleaning. Never yank the cord to pull plug from the outlet. Grasp the plug and pull to disconnect

H. Do not use an appliance for other than intended use. The use of attachments not recommended or sold by the appliance manufacturer may cause an unsafe condition.

I. Do not install or store the appliance where it will be exposed to the weather or to temperatures below freezing.

J. Make sure an appliance mounted on a tank is securely installed before operating it.

K. Read and observe all the important notices on the appliance.

L. This Appliance has a polarized plug (one blade is wider than the other). As a safety feature, this plug will fit in a polarized outlet only one way. If the plug does not fit fully in the outlet, reverse the plug. If it still does not fit, contact a qualified electrician. Never use with an extension cord unless plug can be fully inserted. Do not attempt to defeat this safety feature.

M. This appliance is intended **FOR HOUSEHOLD USE ONLY**. If an extension cord is necessary, a cord with a proper rating should be used. A cord rated for less amperes or watts than the appliance rating may overheat. Care should be taken to arrange the cord so that it will not be tripped over or pulled.

O. Do not let the pump run dry.

Important Safety Instructions

CLEANING

It is important to keep this appliance clean. Always unplug the appliance before performing maintenance or cleaning of the exterior of this hood. Wipe exposed surfaces carefully with a damp terrycloth to remove any dust or mineral deposits which may collect over time. Make sure all surfaces are dry before re-plugging into an electrical outlet. To prevent scratching the aquarium, use a damp terrycloth when cleaning. Never use algae scrapers, scouring pads, razor blades, glass cleaner or other such abrasives.

SERVICING

In order to assure proper electrical connections and polarity, replacement parts and servicing should be performed only by a qualified electrician.

OPERATION

Please carefully read the entire "Owner's Manual" for proper operation procedures before proceeding with turning on this appliance and adding livestock such as fish, corals, and invertebrates.

SAVE THESE INSTRUCTIONS

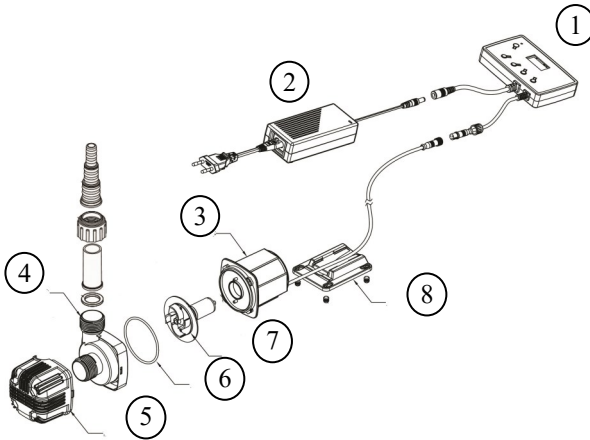
PARTS VIEW MT-604-LED

#	DESCRIPTION
1	WIFI CONTROLLER
2	POWER SUPPLY
3	PUMP MOTOR
4	PUMP HEAD
5	PUMP GUARD
6	IMPELLER ORING
7	IMPELLER ASSEMBLY
8	PUMP BASE

SMART SUBMERSIBLE PUMP

The Accela Pro is a smart submersible pump that can be configured to your unique aquarium. It's compact form factor makes it easy to fit into most all-in-one aquariums. The hybrid impeller design and ceramic drive shaft quietly and efficiently cycle water through your filtration system.

Our network allows you to run the Accela Pro on a schedule, and remotely monitor and adjust your aquarium instantly.

HOME

Conveniently view and manage all your devices. Quick Control options allow you to adjust grouped Accela Pumps at the same time.

FLOW CONTROL

Customize your flow by programming your flow rate. Simply choose your time settings and adjust the flow.

FEED MODE

Stop your flow when its feeding time to assure your feeding is not wasted. Feeding mode will stop the flow rate for 10 mins during feeding time.

Model	Dims	Flow Rate	Max Head
DCB-1500	4.5x2.3x3.3	396	5.5 ft
DCB-2500	5.4x2.9x4.2	660	8.2 ft

WHAT'S INCLUDED INSIDE OF BOX

Carefully unpack your new Accela PRO. Inspect all its components and confirm all parts are included before using.

Report any damages or missing components to:

Toll Free—877-374-9981

Email—warranty@jbjaquarium.com

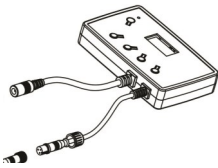

Accela Wifi Controller

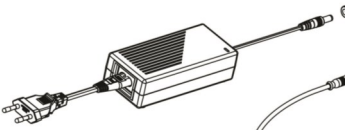

Power Supply

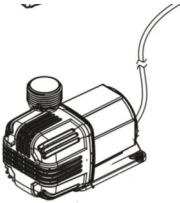

Pump Motor



Barb Hose Connections

GETTING STARTED

Slide base plate onto pump

Attach slip fitting or barb fitting to pump

Slip Fitting—for hard plumbing

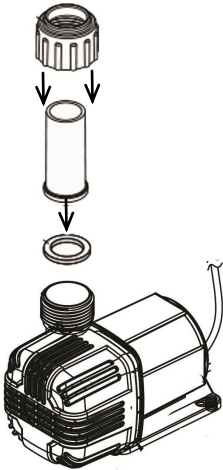

Barbed Fitting—for soft plumbing

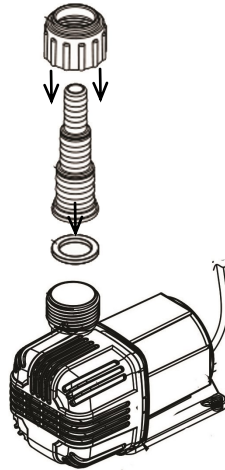

Attach hose/pipe onto barb/slip fitting.

NOTE: PVC Pipe—use PVC cement/glue to securely attach pipe onto slip fitting.

NOTE: Recommended to use a zip tie to securely attach hose onto barbed fitting

PVC Pipe

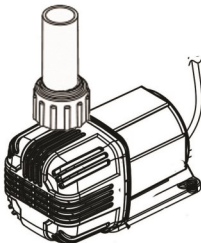

Soft/Vinyl Tubing

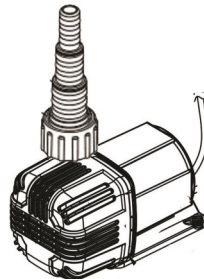
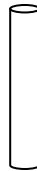

Place pump in desired location.

TURNING ON YOUR LIGHTING SYSTEM

Plug in the Power Supply to the WIFI Controller

Plug in the WIFI Controller to the Pump

Plug Power Supply into approved household outlet.

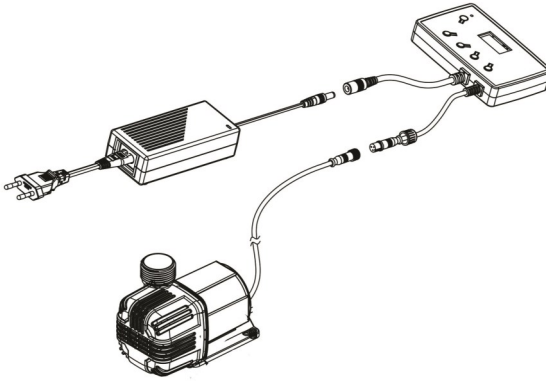

PUMP CONTROLLER



1. Power On/Off Button
2. Flow Rate Control
3. Feed Button/Wave Mode
4. Wifi /Reset Button

MANUAL CONTROLS USING THE CONTROLLER

Press Power button to turn on Accela Pro Pump

FLOW RATE

Control your flow by pressing the UP/DOWN buttons. Set the percentage of flow from 0% to 100%

FEED BUTTON/WAVE FUNCTION

Press Once to set to Wave Function/Pulse Function.

Press Flow Rate button UP/DOWN to adjust the frequency of the Pulse. You can adjust frequency 1 second to 2 seconds.

This will allow the pump to set to automatically pulse.

Press Twice to set to Feed Mode

This stops the flow rate 10 mins during your feeding period.

DOWNLOAD JBJ CONNECT APP

Download the JBJ CONNECT APP /
JBJ INTELLIGENCE APP

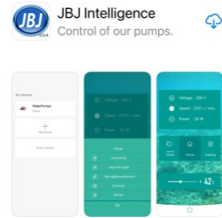

Open APP and register your device.

CONNECT TO PUMP

Open APP and get onto Home Screen.

1. Press (+) on top right corner to add Light.

Add New Equipment

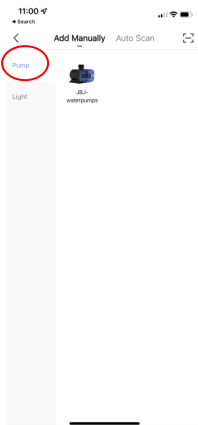
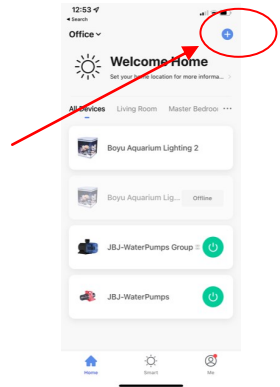

2. Select "Pump" and Press the Pump Image to add pump

CONNECT TO PUMP

3. Reset Controller by pressing the reset button. You will see a rapidly flashing LED light.

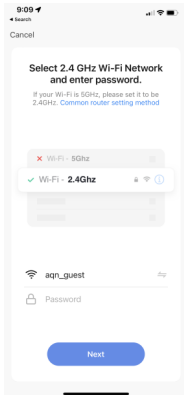
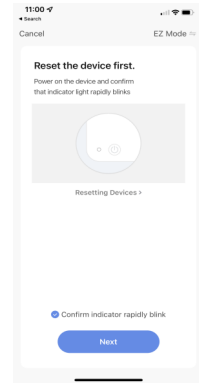

4. Choose the Wifi you want to connect through and enter your password.
Note: Make sure your Wifi signal is at 2.4 GHz.

You are now connected to your Accela Pro pump

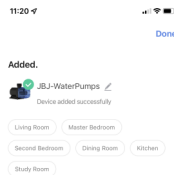

CONTROLLING PUMP WITH WIFI APP

Once you have connected you will be taken to Pump home screen. From here you will see the different modes you can operate your pump.

- Manual Mode
- Custom Modes 1 & 2
- Feeding Mode



Manual Mode

This is the default mode of operation of the pump. Slide the "Flow Rate" toggle to select the desired pump flow. You adjust from 0% to 100%

Custom Mode

You can set your time and flow rate according to your preference.

Feeding Mode

During your feeding period you can select this to stop the flow of your pump.

SETTING YOUR CUSTOM MODE

Press either Custom1 or Custom2 to create your custom flow rates.

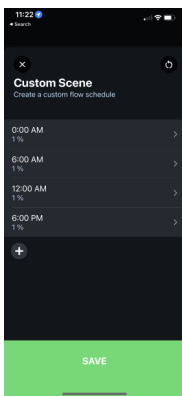
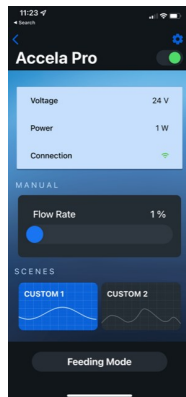

Select Time. In Custom Modes you must set up at least 4 timers.

Press Hour and Minute and scroll up or down to select time.

Press Confirm.

Select AM/PM

Toggle Flow Rate to set your pump flow.

Save and continue until you have set up your desired schedule.

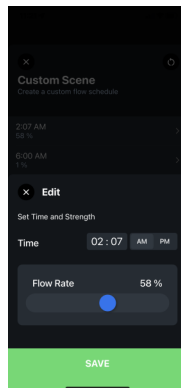

SETTING YOUR CUSTOM MODE

Once you have set up your schedule Press Custom 1 or Custom 2 to run the pump according your desired preference.

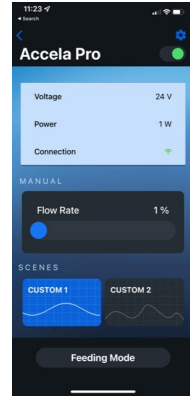

ACCELA PRO

MAINTENANCE

CAUTION—Always unplug before performing any maintenance.

NEVER use soap detergents or any non-recommended cleaning agents around an aquarium

ALWAYS rinse parts with cold water after cleaning

Cleaning/Replacing Impeller

Remove Pump Guard

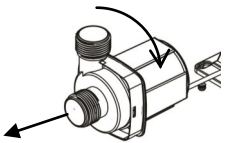
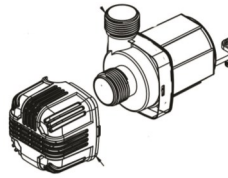

Turn Pump Head and pull away from Pump Motor

Remove Oring & Impeller Assembly.

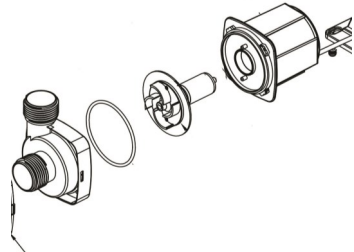

Clean impeller by rinsing under coldwater.

Remove any debris that could be restricting impeller rotations.

Call our Customer Service Department if replacement impeller is needed. 877-374-9981

WARRANTY INFORMATION

1 Year Limited Warranty

This **ACCELA PRO** is warranted to the original purchaser against defective material and workmanship for 1 Year from the date of original purchase. This warranty is valid only under the following conditions: additions, modifications, or changes made to the product by the purchaser and not by the manufacturer shall void this warranty. Damages brought on by abuse, misapplication, or mishandling also voids this warranty.

This warranty is limited to the repair or replacement of the product at the discretion of the manufacturer. This warranty does not cover personal injury, property loss, including livestock or damage (direct, incidental, or consequential) arising out of use of this product. This warranty gives you specific rights and you may also have other rights, which may vary from state to state.

This warranty card must be filled out completely and returned within (14) days from the date of purchase. Failure to do so will void this warranty. A proof of purchase from an authorized dealer must be provided when making a warranty claim.

Upon discovery of a defect, please call us to obtain an RMA #.

Tel: (877) 674 9981

All claims should be sent prepaid to the following address:

Transworld Aquatics Enterprises, Inc.
3730 Unit 3, West Century Blvd.
Inglewood, CA 90308

ACCELA PRO

Please Fill Out Completely and Return within 14 days from date of purchase. *(Please Print)*

Customer Name: _____

Address: _____

City: _____

State: _____ Zip: _____

Phone#: _____

Email: _____

Yes I would like to receive emails on JBJ News—New Products, Sales, Rebates

No I do not want receive emails on JBJ News

Date of Purchase: _____

Model _____

Dealer Purchased From:

Please mail warranty registration and Proof of Purchase to:

Transworld Aquatics Enterprises, Inc.
Attn: Warranty Dept.
3730 Unit 3, West Century Blvd.
Inglewood, CA 90308

You can also register your product on our website—JBJAQUARIUM.COM

rear Off



Fold Here

Stamp

Transworld Aquatic Enterprises, Inc

3730 W. Century Blvd #3

Inglewood, CA 90303

Phone: (877) 374-9981

JBJLIGHTING.COM