



# Accela

Submersible Return Pump



**FP-750**

**FP-1000**

**FP-1500**

**User Guide**

[www.jbjaquarium.com](http://www.jbjaquarium.com)  
[support@jbjaquarium.com](mailto:support@jbjaquarium.com)  
(877) 374 9981

**TRANSWORLD AQUATIC ENTERPRISES, INC.**

3730 W Century Blvd, Ste. #3  
Inglewood CA 90303

---

# Table of Contents

---

<b>4</b>	<b>SAFETY INFORMATION</b>
<b>8</b>	<b>ACCELA SUBMERSIBLE RETURN PUMP</b>
9	Spec Info - FP-750, FP-1000, FP-1500
9	Diagrams - FP-750, FP-1000, FP-1500
<b>10</b>	<b>GETTING STARTED</b>
10	Features
10	Selecting a Location
10	Installation & Operation
11	Maintenance
<b>12</b>	<b>LIMITED WARRANTY</b>
13	Warranty Registration

# Safety Information

---



**WARNING:** To avoid possible electrical shock, do not immerse pump in water. If pump falls into the water, or otherwise becomes wet, do not reach for it until you have first unplugged it.



**CAUTION:** To avoid possible electric shock, pump should be used with a check-valve or positioned higher than the water level.



**DANGER:** For each of the following situations, do not attempt repairs yourself; return the appliance to JBJ Aquariums for service or discard the appliance.

1. If the appliance falls into water, do not reach for it! First unplug it and then retrieve it. If the electrical components of the appliance get wet, unplug the appliance immediately.
2. Carefully examine the appliance after installation. It should not be plugged in if there is water on parts not intended to be wet.
3. Do not operate any appliance if it has a damaged cord or plug, or if it is malfunctioning or if it is dropped or damaged in any manner.
4. When removing filters, air stones or air-operated ornaments from aquarium, do not let water run into

the pump. Leave pump running and prevent back-siphoning by removing the open end of the tubing from the pump nozzle and taping it to the top frame of the aquarium.

5. To avoid getting the appliance plug or receptacle wet, position the aquarium to the side of a wall-mounted outlet. Arrange a "drip loop" for each cord connecting an aquarium appliance to an outlet. The "drip loop" is the part of the cord below the level of the outlet that prevents water from traveling along the cord and coming in contact with the outlet. (If using an extension cord, the "drip loop" is located below the level of the connector.) If the plug or receptacle

gets wet, don't unplug the cord. Disconnect the fuse or circuit breaker that supplies power to the appliance. Then unplug the appliance and examine the outlet for the presence of water.

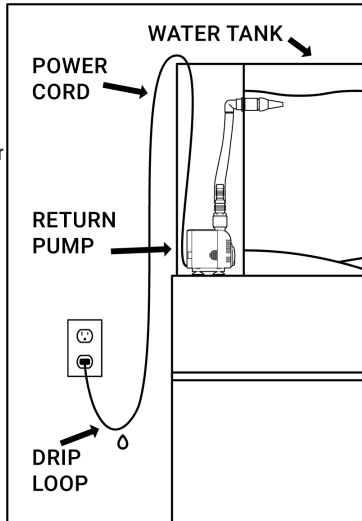

**IMPORTANT:**

1. Close supervision is necessary when using any appliance near children.
2. Always unplug appliance from an outlet when not in use. Never yank cord to remove plug from outlet. Grasp plug and pull to disconnect.
3. Do not use appliance for other than its intended use. The use of attachments not recommended or sold by the appliance manufacturer may cause an unsafe condition.
4. Do not install appliance where it will be exposed to weather, or to temperatures below freezing.
5. Read and observe all important notices on the appliance and in the product literature.
6. If an extension cord is required, a cord with a proper rating should be used. A cord rated for fewer amperes or watts than the total of the various appliance ratings may overheat. Care should be taken to arrange the cord so that it will not be tripped over or pulled.



# Accela

## Submersible Return Pump

---

### FP-750

**TANK SIZE:** Up to 20 gallons

**FLOW RATE:** 198 gph

**MAX HEAD:** 5 ft

**WATTAGE:** 12 w

**OUTLET:** 13 mm

**EXT. SIZE:** 2.9" x 2.2" x 3.6" in

---

### FP-1000

**TANK SIZE:** Up to 30 gallons

**FLOW RATE:** 264 gph

**MAX HEAD:** 6 ft

**WATTAGE:** 16 w

**OUTLET:** 15 mm

**EXT. SIZE:** 3.5" x 2.7" x 4.3" in

---

### FP-1500

**TANK SIZE:** Up to 50 gallons

**FLOW RATE:** 396 gph

**MAX HEAD:** 8 ft

**WATTAGE:** 25 w

**OUTLET:** 1/2 in

**EXT. SIZE:** 4.0" x 3.6" x 5.5" in



## Diagrams

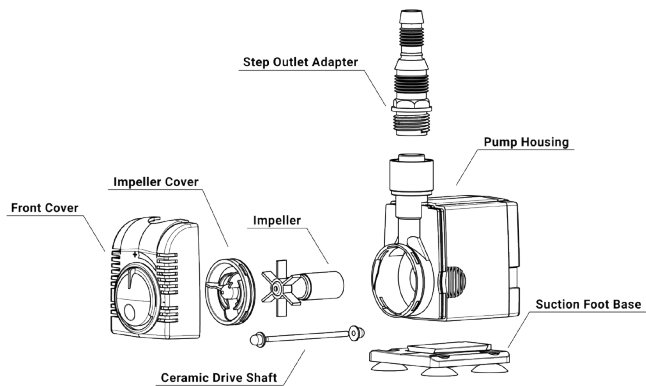

**FP-1000**

# Getting Started

---

## FEATURES

- Energy efficient and silent operation pumps.
- Versatile powerful pumps that can be used in fresh and saltwater applications, protein skimmers, indoor fountains, water-cooling and most return pump applications.

## SELECTING A LOCATION

- Make sure surface is flat and clean from debris to allow the suction cup plate to securely hold pump in place.

## INSTALLATION / OPERATION

1. Slide suction cup plate onto pump.
2. Turn the water flow regulator on the front side of pump to change the flow.
3. Attach slip fitting or threaded fitting onto pump.
4. Attach hose/tubing onto fitting dependent on application.
5. Position/place pump in desired location.
6. Plug pump into approved household socket or power strip.

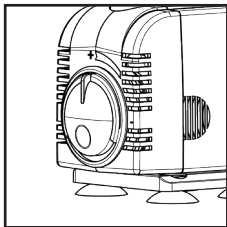

## MAINTENANCE

### 1. Cleaning pump

- Remove front cover grill by pulling front cover from pump.
- Any debris stuck in-between front cover and impeller cover can be rinsed off.
- To clean impeller, turn impeller cover towards left and pull off of pump. Remove impeller and ceramic shaft and rinse/remove any debris.
- Use soft brush to remove any deposits.

### 2. Clean outside of pump with damp cloth and mild detergent.

### 3. Do not use oil on the pump.

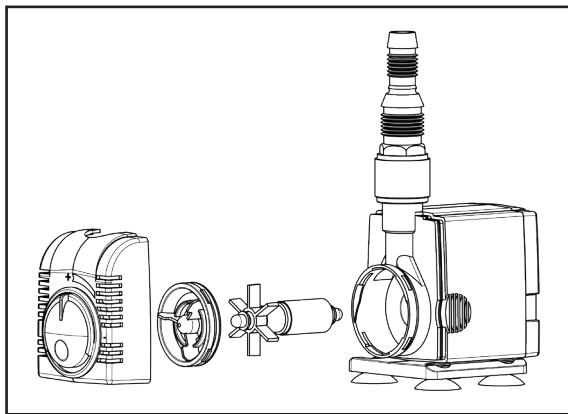

# Limited Warranty

---

## 6 MONTH LIMITED WARRANTY

Accela Submersible Return Pump is warranted to the original purchaser against defective material and workmanship for 6 months from the date of original purchase. This warranty is valid only under the following conditions: additions, modifications, or changes made to the product by the purchaser and not by the manufacturer shall void this warranty. Damages brought on by abuse, misapplication, or mishandling also voids this warranty.

This warranty is limited to the repair or replacement of the product at the discretion of the manufacturer. This warranty does not cover personal injury, property loss, including livestock or damage (direct, incidental, or consequential) arising out of use of this product. This warranty gives you specific rights and you may also have other rights, which may vary from state to state.

This warranty card must be filled out completely and returned within (14) days from the date of purchase. Failure to do so will void this warranty. A proof of purchase from an authorized dealer must be provided when making a warranty claim.

Upon discovery of a defect, please call us to obtain an RMA #.  
Tel: (877) 374-9981

All claims should be sent prepaid to the following address:

**Transworld Aquatics Enterprises, Inc.**  
3730 W Century Blvd, Ste. 3  
Inglewood, CA 90308

Please Fill Out Completely and Return within 14 days from date of purchase. (Please Print)

**NAME:** \_\_\_\_\_

**ADDRESS:** \_\_\_\_\_  
\_\_\_\_\_

**CITY:** \_\_\_\_\_

**STATE:** \_\_\_\_\_ **ZIP:** \_\_\_\_\_

**PHONE:** \_\_\_\_\_

**EMAIL:** \_\_\_\_\_

Yes I would like to receive emails on JBJ News,  
New Products, Sales, Rebates!

**DATE OF PURCHASE:** \_\_\_\_\_

**MODEL:** \_\_\_\_\_

**PURCHASED FROM:** \_\_\_\_\_

Please mail warranty registration and Proof of Purchase to:

**TRANSWORLD AQUATICS ENTERPRISES, INC.**

ATTN: Warranty Dept.

3730 W Century Blvd, Ste. 3

Inglewood, CA 90308

You can also register your product online at

**[www.jbjaquarium.com/register](http://www.jbjaquarium.com/register)**



**TRANSWORLD AQUATIC ENTERPRISES, INC.**

3730 W Century Blvd, Ste. #3  
Inglewood CA 90303

[www.jbjaquarium.com](http://www.jbjaquarium.com)  
[support@jbjaquarium.com](mailto:support@jbjaquarium.com)  
(877) 374 9981